

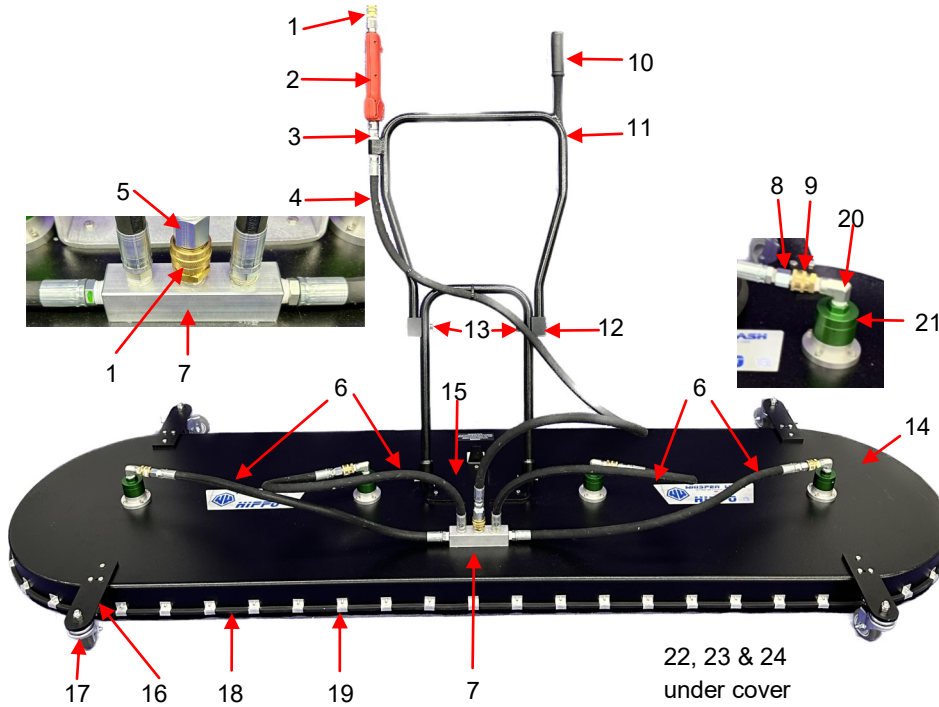

BIG HIPPO

H800



22, 23 & 24
under cover

1.	H104-1/2	Male Socket QD	2	13.	GF506	Knob Assembly	2
2.	H107S	Trigger Gun	1	14.	H805	Cover 8 ft	1
3.	H108	M/M1/2" Connector	1	15.	H422	Handle Base	1
4.	H105	Hose 1/2" x 46"	1	16.	H413	Wheel Bracket	4
5.	H106	Plug 1/2"	1	17.	H414	3" Caster (thick)	4
6.	H109	Hose 1/2" x 37" (lower)	4	18.	H803	Brush	1
7.	M-4W	Manifold 4 way 1/2"	1	19.	WW3116	Clips/Rivets	53
8.	WW118	Plug-Female 3/8"	4	20.	WW3105	Elbow	4
9.	WW104	Male Socket 3/8" QD	4	21.	WW312	Swivel Assembly	4
10.	WW109	Grip	1	22.	M4635	2-Tip Spray Bar	4
11.	H502	High Flow Handle	1	23.	WW301	Spray Tips 2502	8
12.	GF505	Hinge Block	2	OP	High Flow	Spray Bars	

Series 3 Swivel Assembly

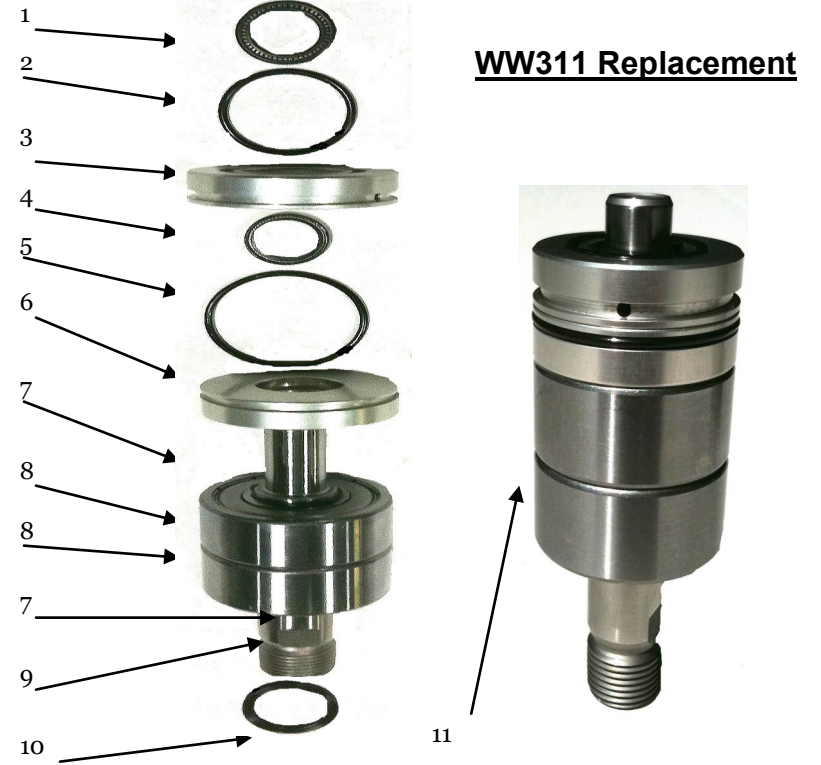

WW311 Replacement

1	WW131	Main Seal	1	6	UC232L-3	Lower Gland	1
2	WW130	Static O-Ring, upper	1	7	WW137	Snap Ring	1
3	UC232-3	Upper Gland Plate	1	8	WW138	Bearing	2
4	WW133	Secondary Seal	1	9	WW136	Rotor Shaft	1
5	WW134-3	Static O-Ring, lower	1	10	WW142-3	Quad Seal	1
				11	WW311	Instant Quick Change Cartridge	1



whisper-wash.com



[facebook.com](https://www.facebook.com)



[YouTube](https://www.youtube.com)



[instagram](https://www.instagram.com)